

MASTERPLANT™

passive electronics, active sound

SIM+

Passive speaker simulation circuit in a desktop box. No power required and no latency added. Combine this unit with a reactive load/attenuator and you have a very practical solution both for live and studio use.

- Transformer balanced outputs
- Works with amplifiers, guitar pedals and line level devices
- Dual balanced line out, speaker simulated and full range
- Completely analogue passive circuit
- Max input power 200W

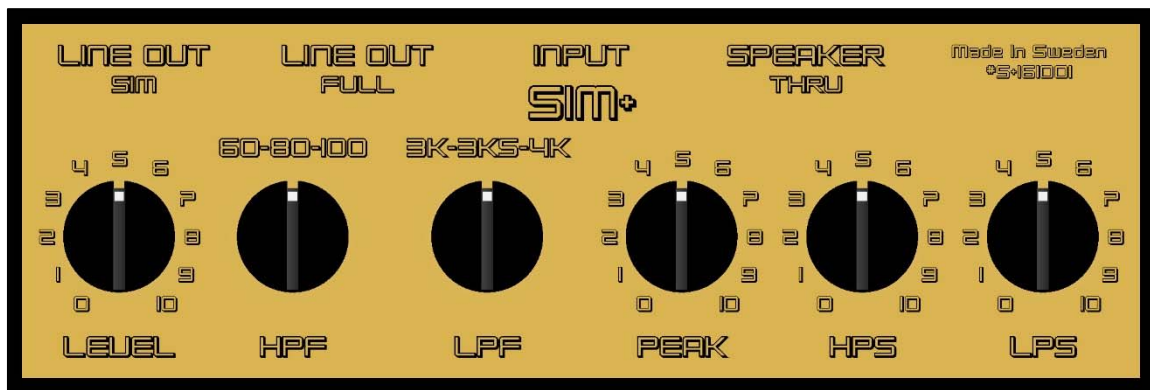

LEVEL controls level of simulated signal
HPF controls peak frequency of high pass/peak filter
LPF controls peak frequency of low pass/peak filter
PEAK controls boost of bass and treble peaks
HPS controls slope of high pass filter
LPS controls slope of low pass filter
Line out Sim outputs a balanced speaker sim signal
Line out Full outputs a balanced full range signal
Input accepts signal from amp, pedal or preamp
Speaker Thru to speaker, load box or attenuator

Frequency response (all controls at max)

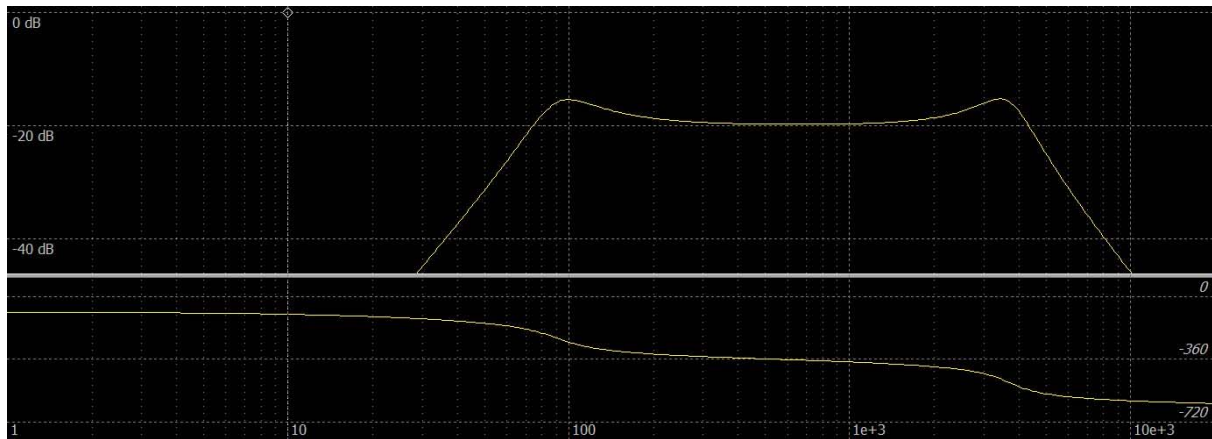

SILENT Recording

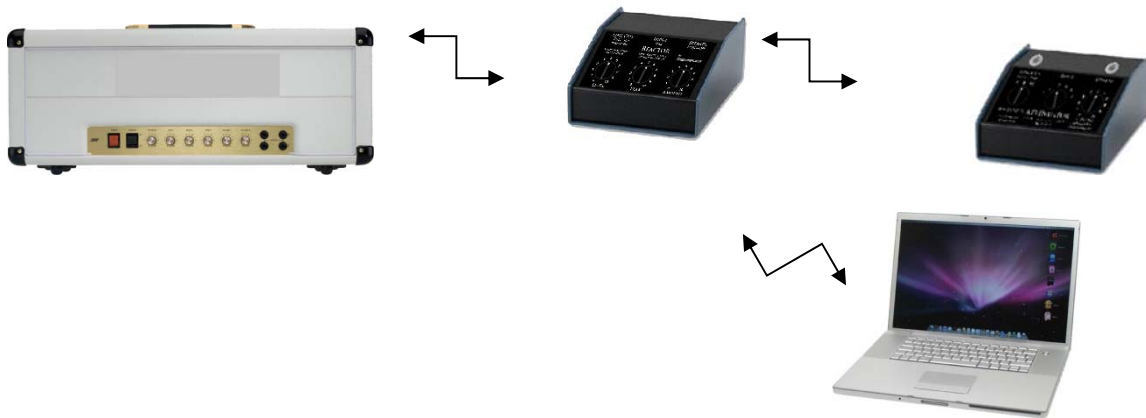

- 1) Match amplifier impedance to load box/attenuator
- 2) Connect amp speaker out to SIM+ input
- 3) Connect SIM+ Thru to load box/attenuator
- 4) Connect Line Out to mixer or audio card
- 5) Adjust speaker simulation or add impulse

If amplifier has, multiple speaker outs then connect load/speaker and SIM+ separately to them.

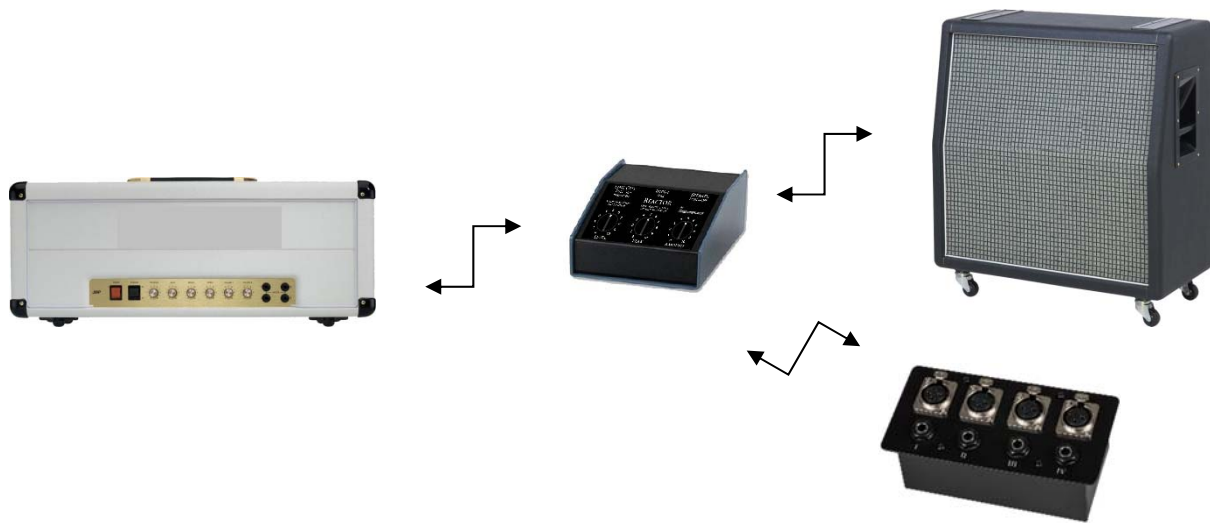

- 1) Match amplifier impedance to speaker
- 2) Connect amp speaker out to SIM input
- 3) Connect SIM+ Thru to speaker
- 4) If amp has another speaker out than connect this one to speaker
- 5) Connect SIM+ balanced line out to stage box
- 6) Adjust speaker simulation to taste

FAQ

Can I use this unit without a speaker or load box connected?

No! Your tube amp must always have some form of load connected.

Will it work with a distortion pedal or preamp?

Yes! In this case, you should connect it to a microphone input as it has more gain available than a line input.

Can the output drive a pair of headphones?

Yes, but a line level device will probably not be enough unless you have headphones that are extremely easily driven.

What does the “PEAK” control do?

It controls boost/cut of the frequencies normally pronounced by a closed miked speaker cab.

What do the “LPS/HPS” controls do?

They control the slope of the high pass and low pass filters.

TECH SPEC

- **Input Power:** Max 200W
- **Input:** ¼" TS phone
- **Speaker Thru:** ¼" TS phone
- **Line Out:** 2x Balanced ¼" TRS phone <100Ω
- **Size:** 170x166x58 (mm)

2 year limited warranty

The warranty applies to defective material and workmanship and for the original purchaser when bought from MASTERPLANT or authorised dealer. Opening the unit will void the limited warranty and any required service or update must be performed by MASTERPLANT. A copy of the original receipt must be included with the unit. Warranty will not cover damage caused by misuse or accidents. It will not cover any damage inflicted to other equipment resulting from impedance mismatching or any other faulty use.